



# 18,000 SF LONG ISLAND CITY GROUND FLOOR WAREHOUSE

31-30 Hunters Point Avenue, Long Island City, Queens



## SPACE DESCRIPTION

DY Realty Group has been retained on an exclusive basis to handle the leasing of 31-30 Hunters Point Avenue in Long Island City, Queens.

The property is an 18,000 sf ground floor industrial/flex space with a 15' ceiling height and one drive-in door on Hunters Point Avenue.

Three-street frontage including on Van Dam Street, offers excellent visibility and brand presence. The Long Island Expressway is one block from the property, and the 7 Subway line is just a half mile away, providing unparalleled access to all parts of NYC.

<b>Block / Lot</b>	288 / 37
<b>Space Size</b>	±18,000 sf Ground Fl.
<b>Ceiling Height</b>	15'
<b>Loading</b>	1 Drive-in Door
<b>Zoning</b>	M2-1
<b>Sprinkler</b>	Fully Sprinklered
<b>Power</b>	Heavy Power
<b>Heat</b>	Gas
<b>Subway</b>	10 Minute Walk To <b>7</b>
<b>Highways</b>	0.1 Miles To LIE / I-495
<b>Lease Price</b>	Call or E-mail



ALL INFORMATION IS FROM SOURCES DEEMED RELIABLE, BUT SUBJECT TO: ERRORS, CHANGES WITHOUT NOTICE, PRIOR SALE OR LEASE, WITHDRAWAL WITHOUT NOTICE. ALL MEASUREMENTS ARE APPROXIMATE.

ALL INFORMATION IS FROM SOURCES DEEMED RELIABLE, BUT SUBJECT TO: ERRORS, CHANGES WITHOUT NOTICE, PRIOR SALE OR LEASE, WITHDRAWAL WITHOUT NOTICE. ALL MEASUREMENTS ARE APPROXIMATE.

# FLOOR PLAN

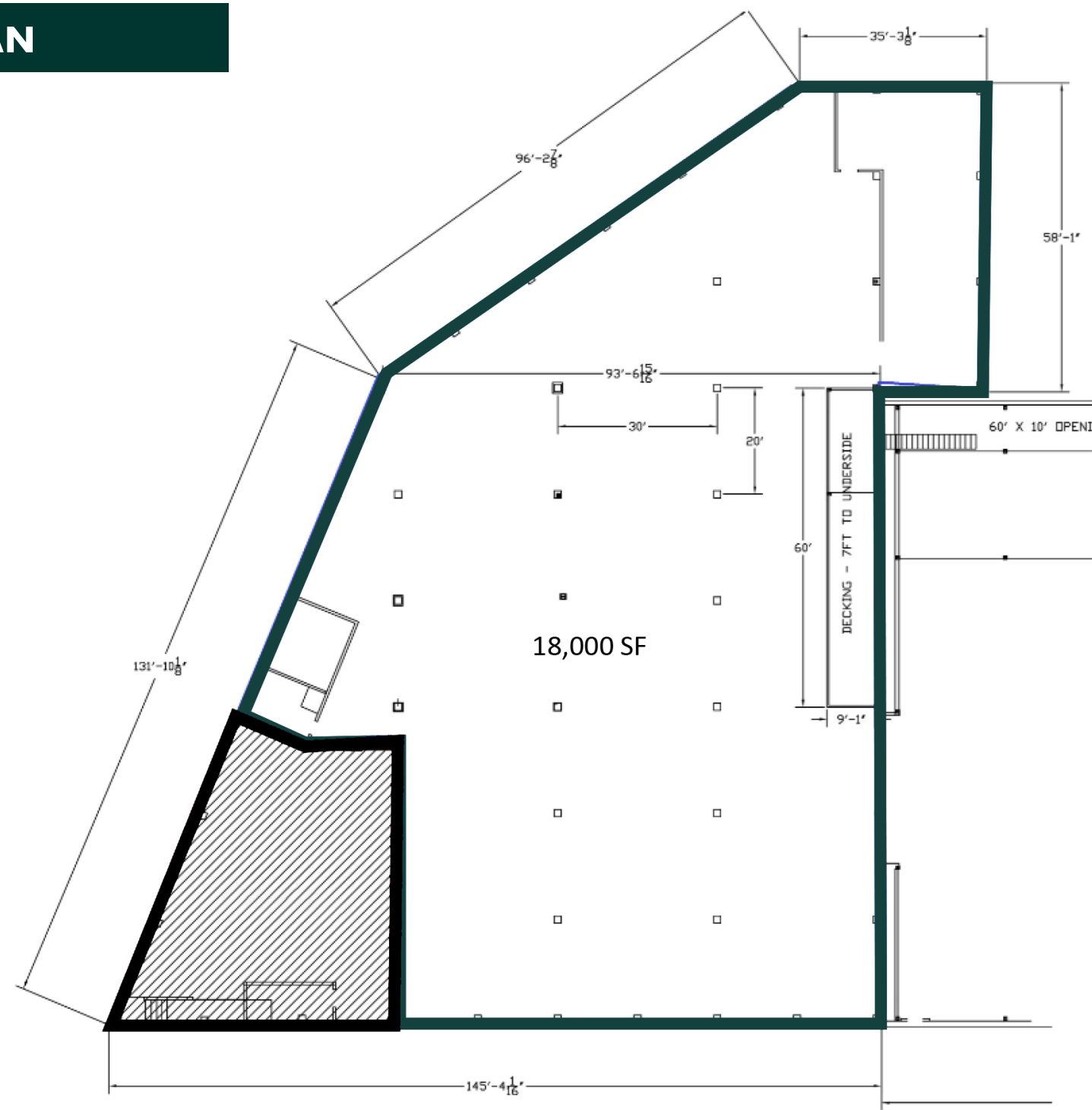

ALL INFORMATION IS FROM SOURCES DEEMED RELIABLE, BUT SUBJECT TO: ERRORS, CHANGES WITHOUT NOTICE, PRIOR SALE OR LEASE, WITHDRAWAL WITHOUT NOTICE. ALL MEASUREMENTS ARE APPROXIMATE.

# LOCATION INFO



ALL INFORMATION IS FROM SOURCES DEEMED RELIABLE, BUT SUBJECT TO: ERRORS, CHANGES WITHOUT NOTICE, PRIOR SALE OR LEASE, WITHDRAWAL WITHOUT NOTICE. ALL MEASUREMENTS ARE APPROXIMATE.



**CONTACT  
EXCLUSIVE  
AGENTS:**

**Ranee Jaber**  
718.729.7474 x135  
917.757.4729 Cell  
RJaber@dyrealty.com

**Mathew Diana**  
718.729.7474 x134  
718.541.6835 Cell  
MDiana@dyrealty.com

